

LEGEND

- 1. Swirler
- 2. Combustion Head
- 3. Primary Gas Orifice
- 4. Secondary Gas Orifice
- 5. Gas Pressure Gauge
- 6. Butterfly Gas Valve
- 7. Linkage Arm - Butterfly Gas Valve
- 8. Air Flow Switch Assembly
- 9. Gas Pilot Ignitor Assembly
- 10. Ignition Electrode and Insulator Assembly
- 11. Orifice - Gas Pilot (if used)
- 12. Ignition Wire
- 13. Pilot Boot
- 14. Primary - Secondary Air Sleeve
- 15. Support - Burner
- 16. Gas Pilot Solenoid Valve
- 17. Gas Pilot Regulator
- 18. Burner Housing
- 19. Access Plate
- 20. Pilot Air Supply Tube
- 21. Pilot Air Supply Fitting
- 22. Bushing
- 23. Ignition Wire Bracket
- 24. Knob - Primary-Secondary Air Sleeve
- 25. Allen Screw - Knob - Primary-Secondary Air Sleeve (if used)
- 26. Gas Pilot Ignition Transformer
- 27. Bracket
- 28. Rod - Primary-Secondary Air Cylinder Linkage
- 29. Right Hand Actuator Cam Assembly
- 30. Left Hand Actuator Cam Assembly
- 31. Sight Tube - Flame Scanner
- 32. Adapter - Flame Scanner
- 33. Flame Scanner
- 34. Spacer Electric Motor
- 35. Electric Motor
- 36. Motor - Modulating
- 37. Hub
- 38. Linkage Arm
- 39. Ball Joint Connector
- 40. Linkage Rod
- 41. Bracket Assembly - Adjustable Modulating Motor
- 42. Bracket - Adjustable Modulating Motor (top)
- 43. Bracket - Adjustable Modulating Motor (bottom)
- 44. Blower Wheel
- 45. Split Taper Bushing - Blower Wheel
- 46. Air Inlet Cone
- 47. Air Inlet Louver Box Assembly
- 48. Linkage Assembly - Air Louvers
- 49. Linkage Arm
- 50. Housing - Air Inlet Louver Box
- 51. Air Inlet Louver
- 52. Air Inlet Driver - Louver
- 53. Louver Access Plate
- 54. Linkage Arm
- 55. Keeper
- 56. Jackshaft Assembly
- 57. Air Diffuser
- 58. Characterized linkage assembly (gas)
- 59. Characterized linkage assembly (oil)

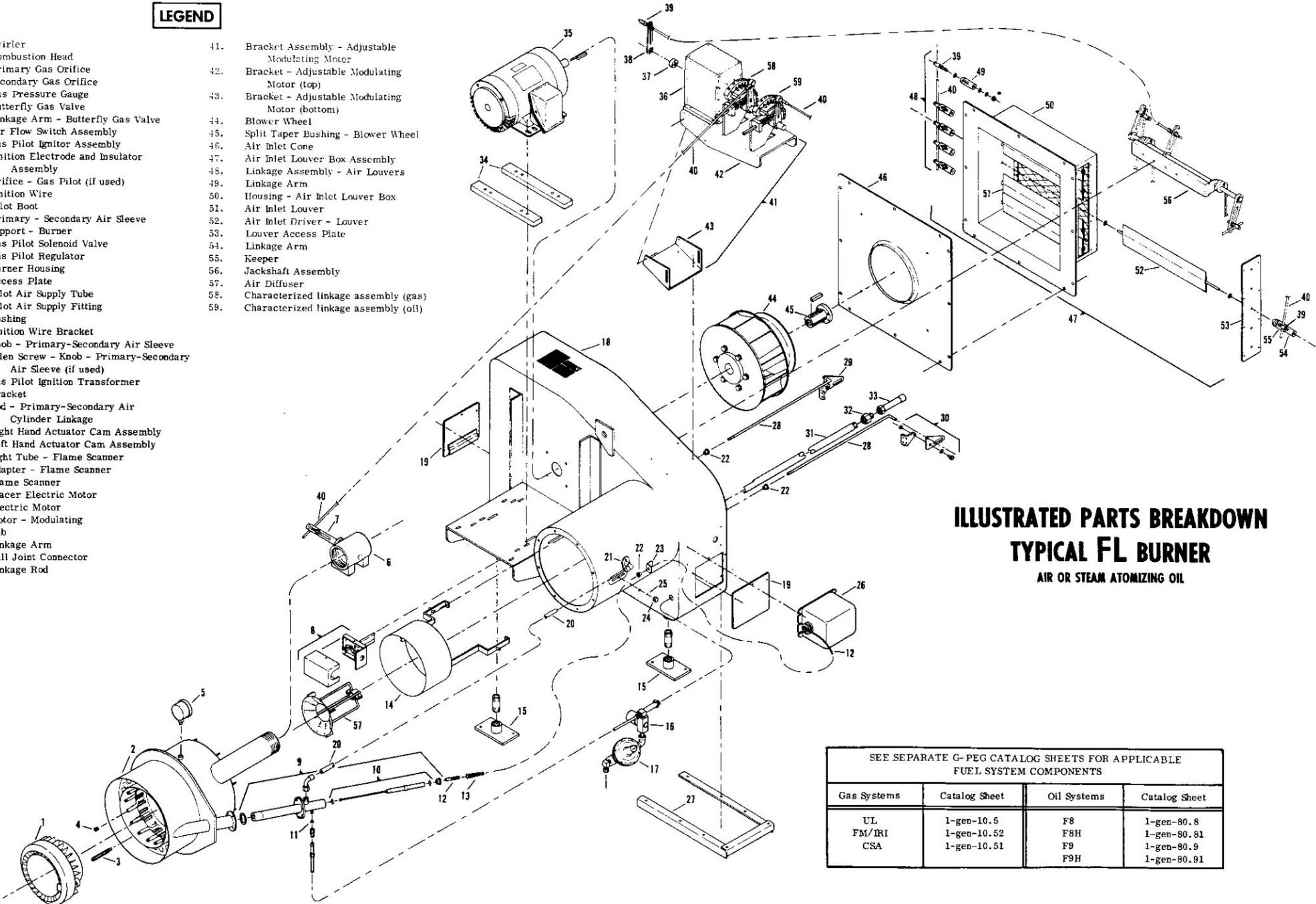

**ILLUSTRATED PARTS BREAKDOWN
TYPICAL FL BURNER
AIR OR STEAM ATOMIZING OIL**

SEE SEPARATE G-PEG CATALOG SHEETS FOR APPLICABLE FUEL SYSTEM COMPONENTS

Gas Systems	Catalog Sheet	Oil Systems	Catalog Sheet
UL	1-gen-10.5	F8	1-gen-80.8
FM/IRI	1-gen-10.52	F8H	1-gen-80.81
CSA	1-gen-10.51	F9	1-gen-80.9
		F9H	1-gen-80.91